



## TECHNICAL SPECIFICATION

### Beam Clamp

Used as a hanger with back and bottom thread rod connections

Robust metallic construction

Material: Iron

Finish: Electrogalvanized

(Use suffix HDG with Cat No. for Hot Dip Galv.)

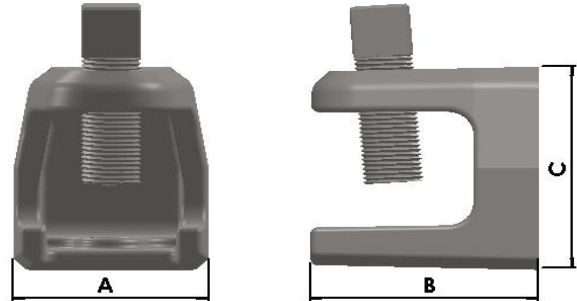

CATNO.	THREAD ROD		DIMENSIONS		
	SIZE	SIZE	A	B	C
BC100	1"	1/4"	30.16	34.93	34.93
BC200	2"	3/8"	45.80	44.60	44.80
BC250	2-1/2"	1/2"	60.33	60.33	53.98

\*\* All dimensions in mm