



## TECHNICAL SPECIFICATION

### Conduit Coupling

Used to connect conduits of same size

Blasted surface for better gripping

**Material:** Steel

**Finish:** Electrogalvanized  
(Use suffix HDG with Cat No. for Hot Dip Galv.)

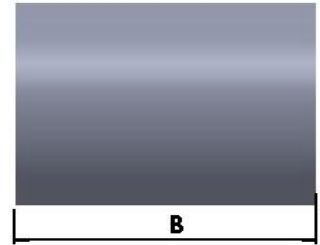
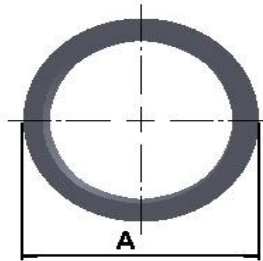

CATNO.	SIZE	DIMENSIONS	
		A	B
CP050	1/2"	25.00	42.00
CP075	3/4"	32.00	42.00
CP100	1"	38.00	51.00
CP125	1-1/4"	47.50	52.00
CP150	1-1/2"	54.75	53.00
CP200	2"	67.35	54.00
CP250	2-1/2"	82.55	81.00
CP300	3"	98.30	85.00
CP350	3-1/2"	114.30	87.00
CP400	4"	123.50	90.00
CP500	5"	152.50	101.00
CP600	6"	183.00	108.00

\*\* All dimensions in mm