



## TECHNICAL SPECIFICATION

### Locknut

Used to connect the conduit or fitting to enclosure

Material: Steel

Finish: Electrogalvanized  
(Use suffix HDG with Cat No. for Hot Dip Galv.)

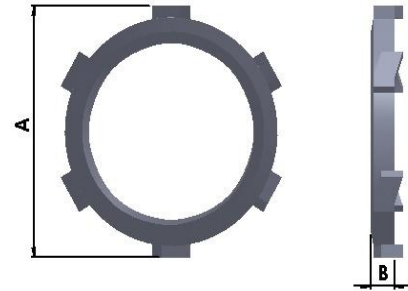

CATNO.	SIZE	DIMENSION	
		A	B
LN050	1/2"	28.70	3.30
LN075	3/4"	35.10	3.30
LN100	1"	42.20	4.80
LN125	1-1/4"	57.90	4.80
LN150	1-1/2"	60.50	4.80
LN200	2"	73.20	4.80
LN250	2-1/2"	90.40	9.70
LN300	3"	108.00	9.70
LN350	3-1/2"	122.20	9.70
LN400	4"	138.20	9.70
LN500	5"	169.90	12.70
LN600	6"	201.70	12.70

\*\* All dimensions in mm