

TECHNICAL SPECIFICATION

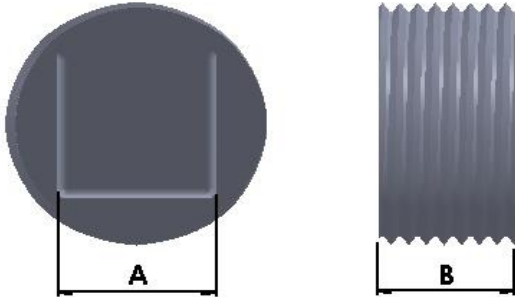

Recessed Head Plugs

Used to close the threaded hub

Recessed head

Material: Iron
(Use suffix S with Cat No. for Steel)

Finish: Electrogalvanized
(Use suffix HDG with Cat No. for Hot Dip Galv.)

| CATNO. | SIZE | DIMENSION | |
|--------|--------|-----------|-------|
| | | A | B |
| RPG050 | 1/2" | 10.20 | 12.21 |
| RPG075 | 3/4" | 13.41 | 13.52 |
| RPG100 | 1" | 13.41 | 19.54 |
| RPG125 | 1-1/4" | 19.00 | 20.00 |
| RPG150 | 1-1/2" | 19.00 | 20.20 |
| RPG200 | 2" | 25.80 | 20.56 |
| RPG250 | 2-1/2" | 19.80 | 25.40 |
| RPG300 | 3" | 19.65 | 25.40 |
| RPG350 | 3-1/2" | 19.80 | 28.30 |
| RPG400 | 4" | 19.83 | 30.20 |
| RPG500 | 5" | 19.72 | 32.10 |
| RPG600 | 6" | 19.80 | 32.10 |

** All dimensions in mm

