



## TECHNICAL SPECIFICATION

### Right Angle Conduit Support

Used for right angle run of conduit from mounting surface

Material: Iron

Finish: Electrogalvanized  
(Use suffix HDG with Cat No. for Hot Dip Galv.)

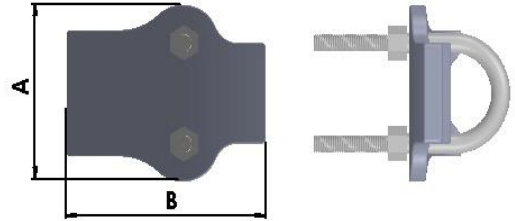

| CATNO. | SIZE   | DIMENSIONS |       |
|--------|--------|------------|-------|
|        |        | A          | B     |
| RCS050 | 1/2"   | 47.00      | 51.00 |
| RCS075 | 3/4"   | 55.00      | 53.00 |
| RCS100 | 1"     | 65.00      | 53.00 |
| RCS125 | 1-1/4" | 74.00      | 54.00 |
| RCS150 | 1-1/2" | 82.00      | 55.00 |
| RCS200 | 2"     | 95.00      | 63.00 |

\*\* All dimensions in mm