

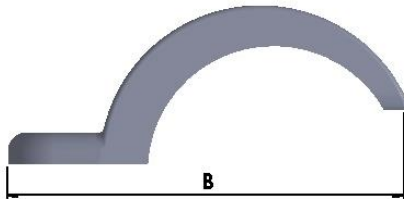

## TECHNICAL SPECIFICATION



### Rigid Conduit Strap

Used to fasten conduit to mounting surface

**Material:** Iron

**Finish:** Electrogalvanized  
(Use suffix HDG with Cat No. for Hot Dip Galv.)

CATNO.	SIZE	SCREW SIZE	DIMENSIONS		
			A	B	C
RST050	1/2"		17.00	50.25	23.10
RST075	3/4"		17.50	59.87	23.70
RST100	1"		21.00	66.90	25.75
RST125	1-1/4"		23.00	78.50	40.00
RST150	1-1/2"		26.25	94.00	52.00
RST200	2"		35.75	114.00	61.10
RST250	2-1/2"		36.00	150.00	78.00
RST300	3"		39.00	183.00	90.00
RST350	3-1/2"		50.00	216.00	110.00
RST400	4"		53.00	226.00	122.00
RST500	5"		65.00	278.00	165.00
RST600	6"		75.00	318.00	190.00
RST800	8"		80.00	350.00	225.00
RST1000	10"		85.00	390.00	275.00



\*\* All dimensions in mm